

## Stain removal

### Dabbing method



**10410** Karpfom 500 ml aerosol can



**10420** Karspray 300 ml aerosol can



**10403** Karpotek







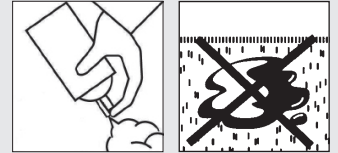

## Stain removal

### Dabbing method



#### Description

<b>Definition / objective</b>	<b>Removing small stains (spot-cleaning)</b> from surfaces and floor coverings using the stain remover and an absorbent cloth. Suitable for textile floor coverings, carpets, textiles and upholstery.	
<b>Preparatory work</b>	Select suitable products to match the surface to be cleaned (type / square metres) and the type of soiling.	
	Select a suitable ready-to-use stain remover (spray or foam).	
		Put up the warning sign.
	Dab fresh stains with a clean, absorbent and colour-fast cloth.	
	Use a plastic spatula to carefully break up and lift any encrustations.	
	 	Thoroughly remove any loose dirt (dry vacuuming or brush vacuuming).
<b>Colour fastness pre-test:</b> Spray a small amount of stain remover onto an inconspicuous spot of the surface and leave for a short while to take effect. Then carefully dab it with the white, lint-free cloth. Continue if the surface is colour-fast (the method is otherwise unsuitable).		
<b>Main task</b>	 	Identify the type of stain and treat it with the appropriate stain remover from a distance of about 10 cm (spray or foam).
		Allow the stain remover to take effect, but don't let it dry.
	Use a suitable cloth to dab away the dissolved stain, moving from the outside towards the centre.	
	Change the cloth when it gets dirty and put it with the dirty laundry or dispose of it.	
	Repeat the process until the stain is removed.	
	As needed: Evenly straighten the carpet pile at the stain location with the soft hand brush.	
<b>Final steps</b>		Allow the treated surface to dry <b>completely</b> .
	Remove the warning sign.	
	Wash the reusable cloths in the washing machine.	
	Dispose of any waste.	
<b>Comments</b>	Clean the cleaning equipment and replace as needed.	
	<ul style="list-style-type: none"> <li>- Wear the personal protective equipment (PPE) required by company regulations, safety data sheets and / or instructions for use.</li> <li>- Always check in advance which product meets your requirements (see Wetrok Cleaning &amp; Care Instructions).</li> <li>- Wetrok AG accepts no liability for damage caused by improper use or incorrect product selection.</li> </ul>	